

SPECIFICATIONS

Current Rating: 2A
 Contact Resistance: 20MΩ Max
 Insulation Resistance: 1000MΩ Min
 Withstand Voltage: 600V AC / Minute
 Operation Temperature: -40°C to +105°C
 Contact Materials: Brass
 Contact Plating: Au Or Sn over 50 Ni
 Insulator Materials: PBT / PA6T..

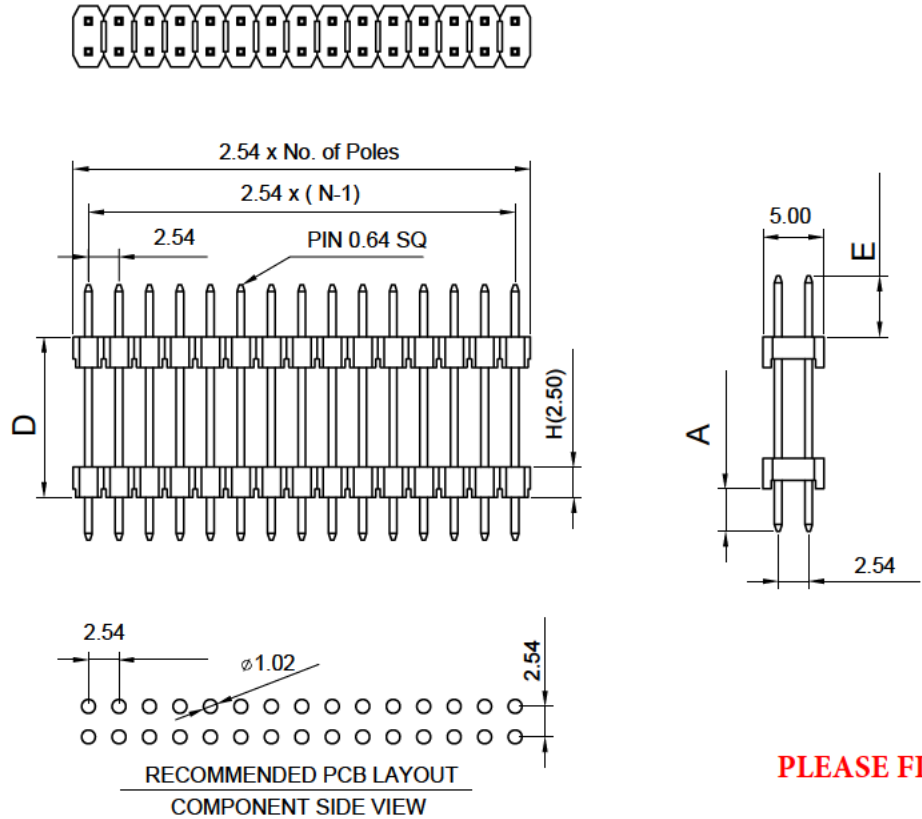

SM C02 2200 XX FS (A= ,C= ,D= ,E=) - Y

XX - Contact No.:2-80

Y- Packing: unmarked - bag

- T -Tube
- R - Reel Packing
- P - Pad + Tube Packing
- Q - Pad + Reel Packing

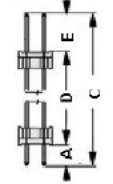

Example: SM C02 2200 10 FS (A=3,0; C=19,9; D=10,5; E=6,4) - T

= Header Dual Rows Dual Insulator; RM2,54; 10 Contacts;
 Dimension: A=3,0mm; C=19,9mm; D=10,5mm; E=6,4mm
 Packing: Tube

PLEASE FILL IN: Contact No.:
 Dimensions: A: D: E: C (A+D+E):
 Packing:

| | | | | | | | | | | | |
|-----|--------------|----------|--------------------------------------|----|-------|-------------|------------|------------------------|--|------------------------------|---|
| E | | | Units | mm | Scale | 2:1 | Drawing By | Date | SCHMID-M | | |
| D | | | Tolerance Unless Otherwise Specified | | | Revised By | Date | Sheet | | | |
| C | | | .X ~ ±0.30 | | | Approval By | Date | Part No. | Customer Header SM C02 2200 XX FS | | |
| B | | | .XX ~ ±0.25 | | | | | Title | A (xx); C(xx); D(xx); E(xx) XX: Number Pin | | |
| A | RELEASED | 01/06/18 | .XXX ~ ±0.20 | | | | | Third Angle Projection | | 2.54mm Pin Header Double Row | |
| REV | DESCRIPTION. | Date | Angle ~ ± 3° | | | | | | | REV | A |